

# AIR-JECT AERATOR

## THE FOUR IN ONE

Aeration encourages roots to grow deeper by increasing the oxygen supply to the root zone for healthy green grass. The Bannerman BA-4 Air-Ject Aerator is a commercial grade self-propelled, walk behind aerator. The Spiker Tine is used for surface aeration. The Air-Ject can now be fitted with a total of 4 different types of tines: Core, Slitter, Fracture and Spiker. Truly the "Four in One" aerator. Our compact size allows for easy and safe operation in confined areas, and less operator fatigue. The new Tine Reel assemblies allow for smoother operation, and more holes per square yard. Ballast weight bars maintain maximum penetration and balance.

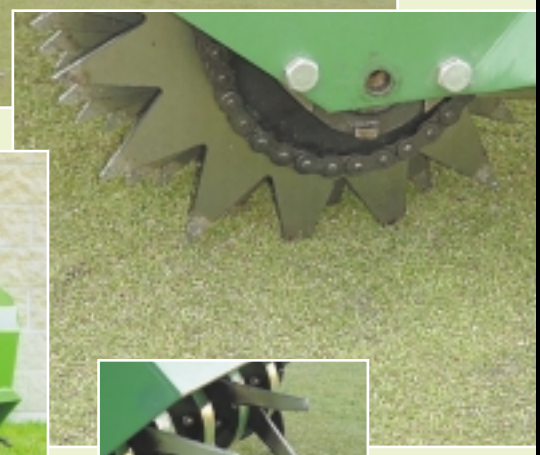

- **ROLL AROUND HANDLE DESIGN WITH SAFETY CLUTCH**
- **EASY ROLL PNEUMATIC TIRES**



0 0 6 7 0

[www.sportsturfmagic.com](http://www.sportsturfmagic.com)  
CANADA 1-800-325-4871  
USA 1-800-665-2696

41 Kelfield Street, Rexdale, Ontario, Canada M9W 5A3

# BANNERMAN BA-4 AERATOR

## SPECIFICATIONS

### Power

Four Cycle Engine	Honda - Model #: GX120
Horsepower	4.0
Kilowatts	2.9
Displacement	118 c.c.
Gear Reduction	6 to 1

### Unit

Machine Type	Self-propelled walk behind aerator
Frame	1/4 in. (0.63 cm) Plate Steel
Tine Reel	1-1/2 in. (3.75 cm) tine tube with 5-1/4 in. (13.13 cm) tine plates
Tine Reel Axle	3/4 in. (1.69 cm) cold rolled shafting
Lubrication	Grease fitting on tine reel and wheels
Clutch	Belt tightener

### Tines

Tines available	4 Types - Core Tines, Slitter/Slicer Tines, Fracture Tines, Spiker Tines
Core Tine material	Hardened steel
Core Tine depth	3 in. (7.50 cm)
Core Tine diameter	1/2 in. (1.25 cm)
Core Tines per unit	25
Core Tines per plate	5
Slitter/Slicer Tine material	Hardened surgical steel
Slitter/Slicer Tine depth	5 in. (12.50 cm)
Slitter/Slicer Tine length	5 1/2 in. (13.75 cm)
Slitter/Slicer Tines per unit	25
Slitter/Slicer Tines per plate	5
Fracture Tine material	Drop forged steel
Fracture Tine depth	5 in. (12.50 cm)
Fracture Tine length	5 1/2 in. (13.75 cm)
Fracture Tines per unit	12
Fracture Tines per row	3

### Spiker Tine

Material	Hardened surgical steel
Depth	up to 1" (50mm)
No. per unit	13
No. points per	on 1-1/4" centres (32mm)
Diameter	

### Aeration Patterns

Aerating width	18 in. (45 cm)
Core Tine pattern	4 in. x 11 in. (10 cm x 27.5 cm)
Holes per square yard	36
Slitter/Slicer Tine pattern	4 in. x 11 in. (10 cm x 27.5 cm)
Holes per square yard	36
Fracture Tine pattern	14 in. x 5 in. (35 cm x 12.5 cm)
Holes per square yard	18

### Miscellaneous

Tires	2 (two) Pneumatic 410/350 x 4 inch with bearings
Handle	1 inch tubular with foam grip
Weights	4 bars 16 lbs. each (1 in. x 4 in. x 14 in.)
Weights	4 bars 7.25 kg each (2.5 cm x 10 cm x 35 cm)

### Dimensions

Working weight	240 lbs. (109.9 kg)
Working width	27 in. (67.50 cm)
Working length	25 in. (62.50 cm)
Working height	39 in. (97.50 cm)
Shipping weight	250 lbs. (112.6 kg)



## TINE INFORMATION

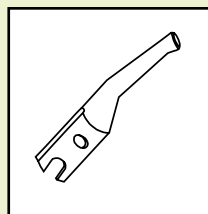

**Part #08063**  
**1/2" Core Tine**

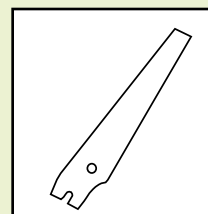

**Part #08067**  
**Slitter/Slicer Tine**

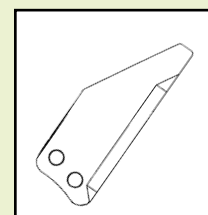

**Part #08112**  
**Fracture Tine**

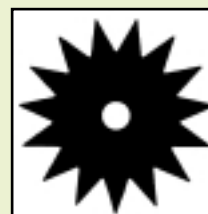

**Part #08099**  
**Spiker Tine**